

Break-out Space | Shared Vestibule

- Space intended for students with direct association with connected classroom(s).
- Vestibule used for interaction and storage prior to entering classroom(s) and can be used while class is in session.
- Lockers or cubbies can be placed along the walls for closed off storage.
- Frees up space for quiet learning activities and teaching wall area.

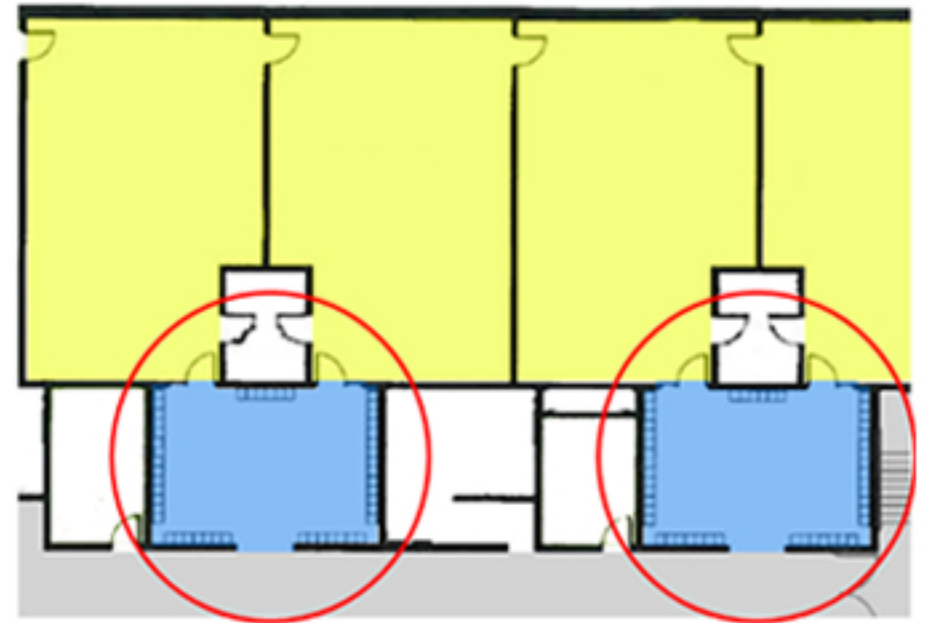

Classrooms – 930 SF
Break-out Space – 340 SF



Classrooms – 900 SF
Break-out Space – 400 SF

Key

- Classrooms
- Break-out Spaces